

# SUNRIDGE

## ICS 02 SERIES

### 2.54 MM CENTER SINGLE -IN- LINE PACKAGE, STAMPED CONTACT

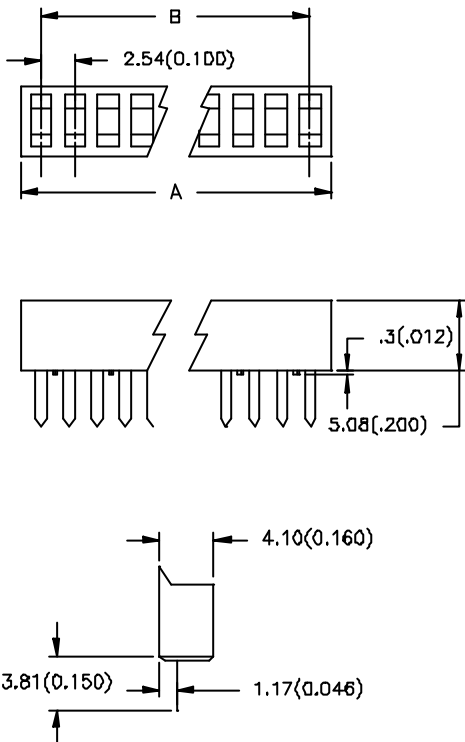

#### P/N DESIGNATION

ICS-02- \_\_\_\_\_  
 NUMBER OF CONTACTS

P/N	DIMENSION mm(inch)	
	A	B
ICS-02-07	17.78(.700)	15.24(.600)
ICS-02-08	20.32(.800)	17.78(.700)
ICS-02-09	22.86(.900)	20.32(.800)
ICS-02-10	25.40(1.000)	22.86(.900)
ICS-02-11	27.94(1.100)	25.40(1.000)
ICS-02-12	30.48(1.200)	27.94(1.100)
ICS-02-14	35.56(1.400)	33.02(1.300)
ICS-02-16	40.64(1.600)	38.10(1.500)
ICS-02-20	50.80(2.000)	48.26(1.900)
ICS-02-21	53.34(2.100)	50.80(2.000)
ICS-02-24	60.96(2.400)	58.42(2.300)
ICS-02-30	76.20(3.000)	73.66(2.900)

## ICS 03 SERIES

### 1.778 MM CENTER DUAL -IN- LINE PACKAGE, STAMPED CONTACT

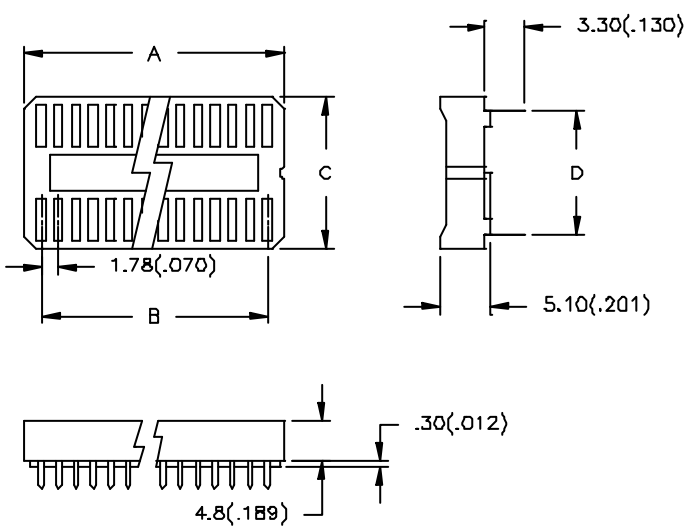

#### P/N DESIGNATION

ICS-03-x \_\_\_\_\_  
 NUMBER OF CONTACTS

#### ROW SPACING

	"C" DIMENSION	"D" DIMENSION
4:	12.65(.498)	10.16(.400)
6:	17.73(.698)	15.24(.600)
7:	21.54(.848)	19.05(.750)

P/N	DIMENSION mm(inch)	
	A	A
ICS-03-x24	21.78(.857)	19.56(.770)
ICS-03-x28	25.17(.991)	23.11(.910)
ICS-03-x30	27.11(1.067)	24.89(.978)
ICS-03-x40	35.84(1.411)	33.78(1.330)
ICS-03-x42	37.62(1.481)	35.56(1.400)
ICS-03-x64	57.18(2.251)	55.12(2.170)