

SUNRIDGE

46XX0L-SERIES

RIGHT ANGLE MOUNT, .590" FOOT PRINT, STANDARD HOUSING, RECEPTACLE

P/N DESIGNATION (REF TO PAGES 2,3 FOR DETAIL)

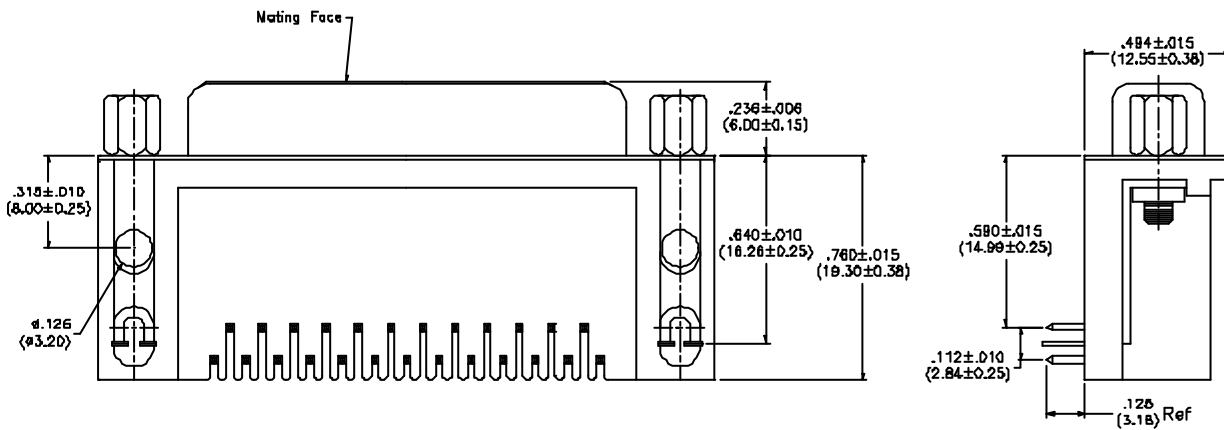
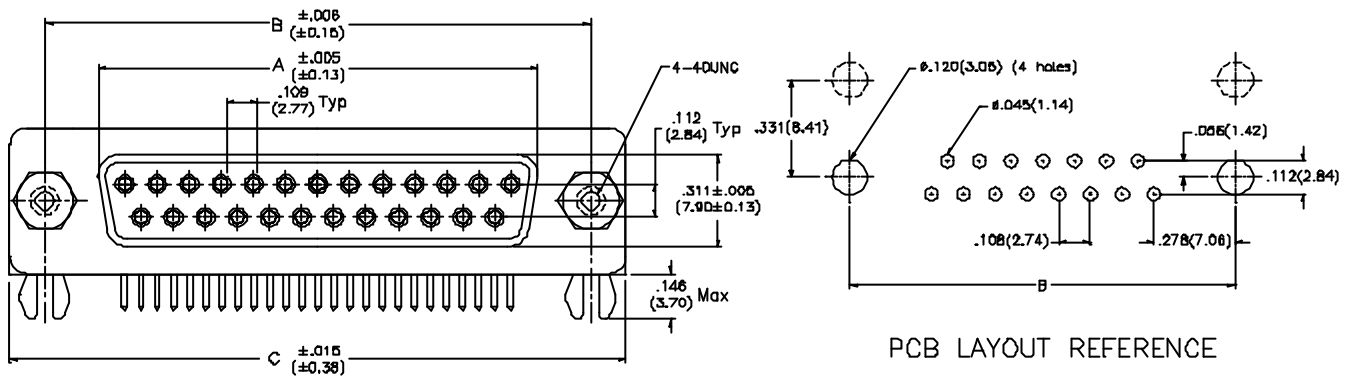
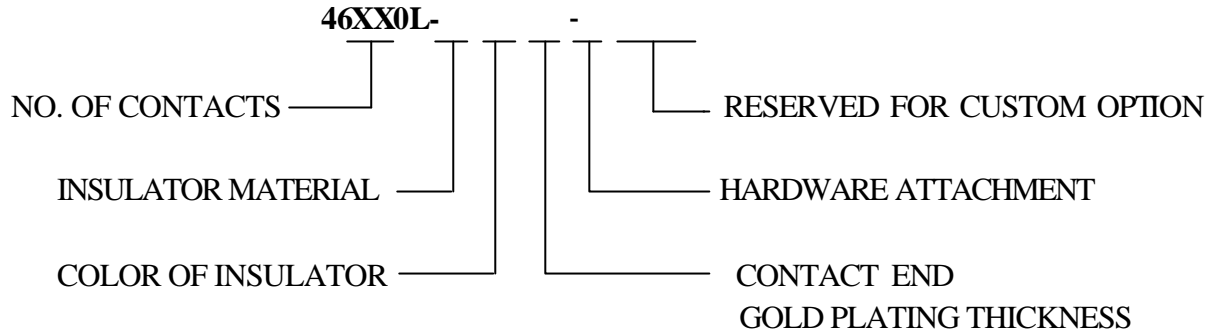

BASIC P/N	NO. OF CONTACT	DIMENSIONS IN (MM)		
		A	B	C
46090L-	9	.643(16.33)	.984(24.99)	1.213(30.81)
46150L-	15	.971(24.66)	1.312(33.32)	1.541(39.14)
46250L-	25	1.511(38.38)	1.852(47.04)	2.088(53.04)
46370L-	37	2.159(54.84)	2.500(63.50)	2.729(69.32)