

Sunridge MCC Series – 6GHz RF Switch Connector

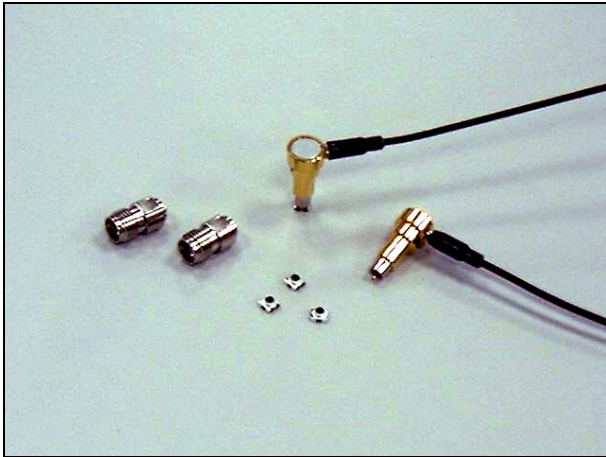

Sunridge MCC RF switch connector addresses the increasing industrial demand where an efficient, accurate and reliable method for antenna verification on board is a must. Typical of Sunridge MC (Miniature Coaxial) RF interconnect family which consists of MCA, MCB, MCC aboard and MCD series; MCC features smaller form factor, light weight and performance up to 6 GHz.



Features

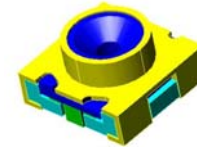

- Space Economy: PCB footprint of 3.0mm x 3.0mm, x 1.8mm height
- Provides a cost effective test point on production PCBA for antenna circuit performance verification.
- Insertion loss: 0.2dB max, VSWR: 1.3 max, Isolation factor: 20 dB min (0 to 3 GHz); 15 dB min (3 to 6 GHz).
- Notch identification for ground and input signal pads.
- Complete offerings of test probe for production set up, and SMA adaptor for test probe calibration.
- Custom engineering design solution available upon request.

Typical application:

Cellular Phone, WiFi, and variety of wireless information devices

Schematic design:

Antenna stays connected to the RF circuit at default setting. When connected to the test probe, the antenna stands alone : for on board verification test, fine tuning, or diagnosis.

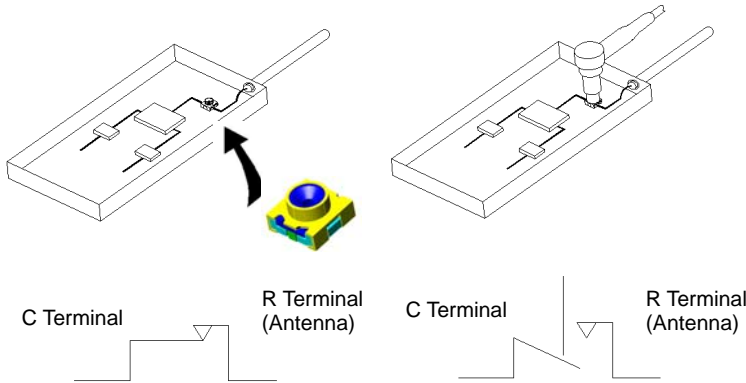

Production Test Socket

Pn: MCC-ST- 00T

- Select copper material for spring contact to ensure reliability.
- Groove feature helps secure connection with test probe.
- High temper plastic resin to sustain IR reflow process.

Characteristics	
Frequency Range	DC to 6GHz
Nominal Impedance	50 ohm
Temperature Range	-40°C to +90°C
Voltage Rating	250Vrms
Contact Resistance	50m ohm max
Withstanding Voltage	AC 300Vms
Insulation Resistance	500m ohm min
Durability	500 Cycles

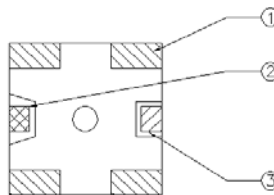
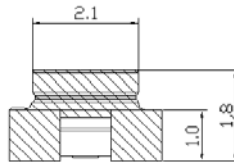
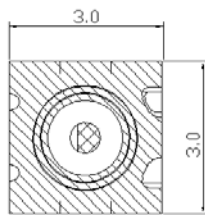

Notes:

- ① Ground Contact: Copper Alloy, silver Plated
- ② Input Contact: Copper Alloy, Gold Plated
- ③ Output Contact: Copper Alloy, Gold Plated
- 4 Insulator: Engineering Plastic

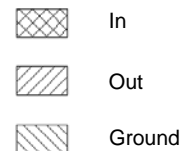
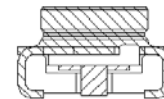

(dimension: mm)



www.sunridgecorp.com

Sunridge Corporation

Specialist in Interconnect Solutions





Test Probe

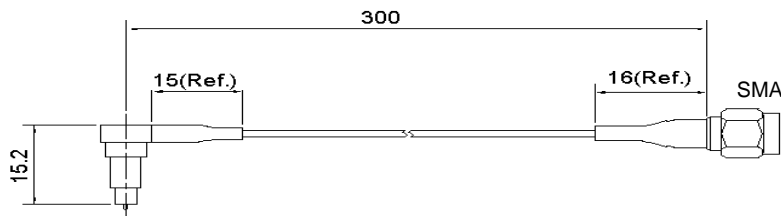

For easy and durable use with production socket Pn MCC-ST-00T.

Cable & RF Connector Selection	Sunridge P/N
Flexible 1.33mm Cable (RG-178 grade), SMA Plug	MCC-TP-300-SMAP201
Flexible 1.33mm Cable (RG-178 grade), SMA Bulkhead Jack	MCC-TP-300-SMAJB201
RG-178 Cable of 1.80mm OD, SMA Plug	MCC- TP-300-SAMP301
RG-178 Cable of 1.80mm OD, SMA Bulkhead Jack	MCC- TP-300-SMAJB301

Characteristics	
Frequency Range	DC to 6GHz
Nominal Impedance	50 ohm
Temperature Range	-40°C to +90°C
Voltage Rating	250Vrms
Contact Resistance	15m ohm max
Withstanding Voltage	AC 300Vms
Insulation Resistance	500m ohm min
Durability	10,000 Cycles

◆ Custom configuration is available upon request.

Correlation Adaptor: MCCP-SMAJ

Efficiency of production probe test is achievable only if the performance characteristics of the test probe itself is a known constant. Probe adaptor provides for an easy hookup from the probe head onto network analyzer, for accurate performance measurement of the test probe cable assembly.

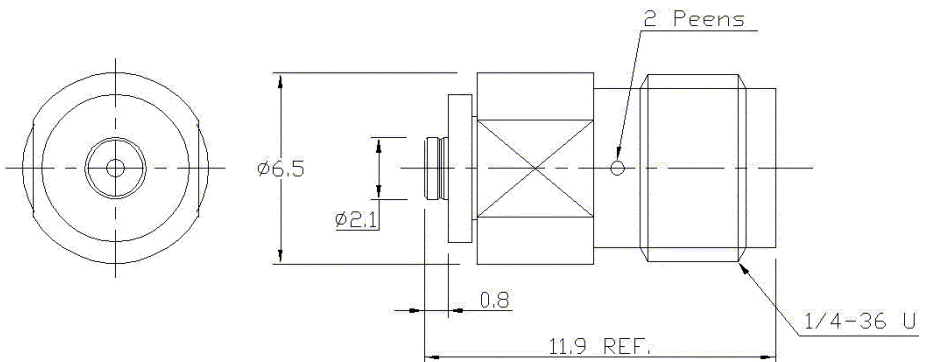

Recommended PCB Layout

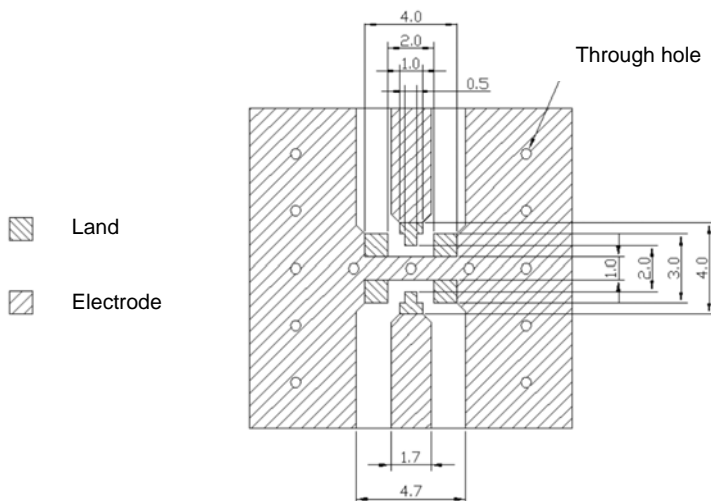

- Land
- Electrode

Probe Correlation Program

To provide a key reference data for production set up, probe calibration program is available. For each test probe purchased, Sunridge can supplement a performance test report and the same probe adaptor with which the test measurement is conducted.

